

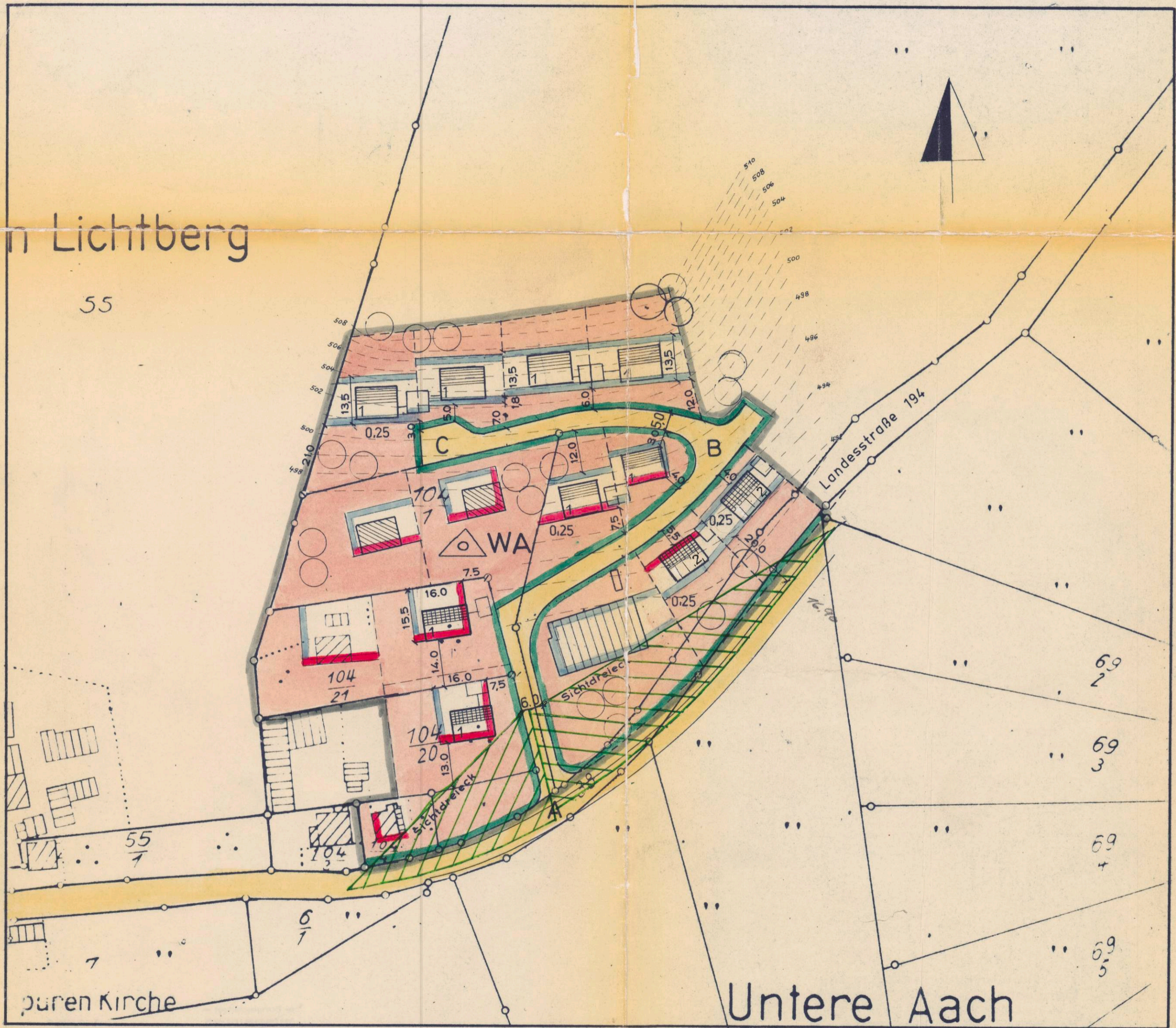





# GEMEINDE WINTERSPÜREN

## BEBAUUNGSPLAN FÜR DAS GEWANN "IM LICHTBERG" STRASSEN - u. BAULINIENPLAN M. 1:1000

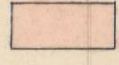
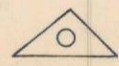

-  NEUFESTZUSTELLENDEN STRASSENBEGRÄNZUNGSLINIE
-  NEUFESTZUSTELLENDEN BAULINIE
-  BAUGRENZE
-  STRASSENVERKEHRS FLÄCHE
-  NICHT ÜBERBAUBARE GRUNDSTÜCKSFLÄCHEN
-  OFFENE BAUWEISE NUR EINZELHAUSER ZULÄSSIG
-  GRENZE DES PLANUNGSGEBIETES
-  WA ALLG. WOHN GEBIET

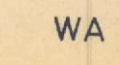
KONSTANZ, DEN 1966  
 DER PLANFERTIGER:  
**ARNO JAHN**  
 BAU-ING. B.D.B.  
 FREIER ARCHITEKT  
 KONSTANZ  
 SALESIANERWEG 1 TEL. 2114

WINTERSPÜREN, DEN 10.3. 1966  
 DER BÜRGERMEISTER:



*Kemp*